



# EQUIPO PESADO



GOMA SOPORTE FLECHA  
CARDAN/  
SOPORTE FLECHA CARDAN/  
TAPAS DE BALERO

1001

DODGE // **DINA**

GMC



CHEVROLET  
DODGE FORD  
DINA GMC

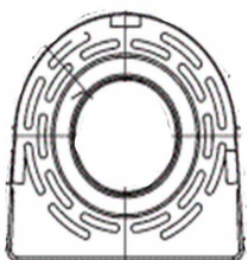
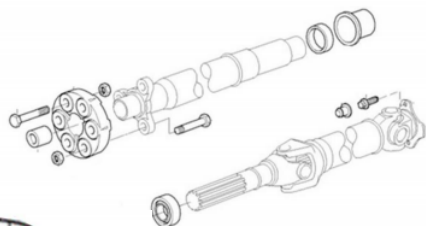

ESPECIFICACIONES

S/BAL/ PARA SOPORTES  
(1003,1002)



1002

DODGE // **DINA**

GMC



CHEVROLET  
DODGE FORD  
DINA GMC

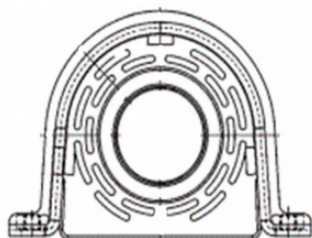
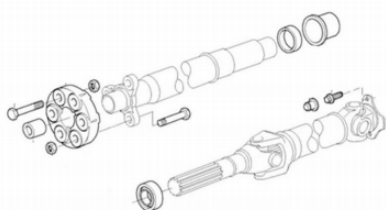

ESPECIFICACIONES

HERRAJE, GOMA PARA  
BAL 88107

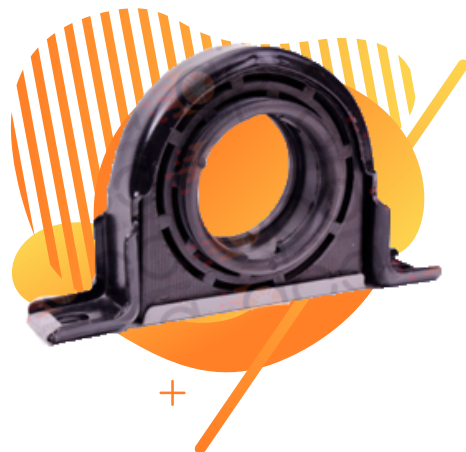

GOMA SOPORTE  
FLECHA CARDAN/  
SOPORTE FLECHA  
CARDAN



EQUIPO  
PESADO

1003

DODGE // **DINA**

GMC



CHEVROLET  
DODGE FORD  
DINA GMC

35 MM

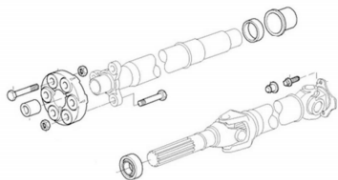
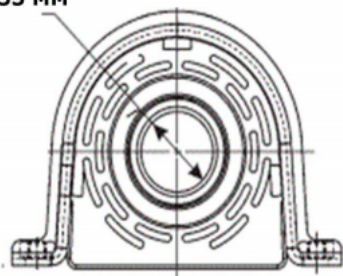

ESPECIFICACIONES

Ø INT. 35MM. BAL 88107

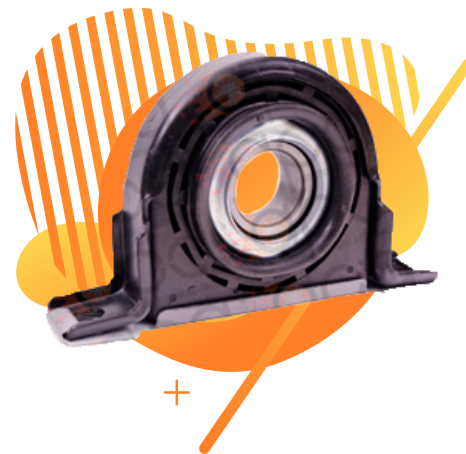

1004

DODGE // **DINA**

GMC



CHEVROLET  
DODGE DINA  
GMC

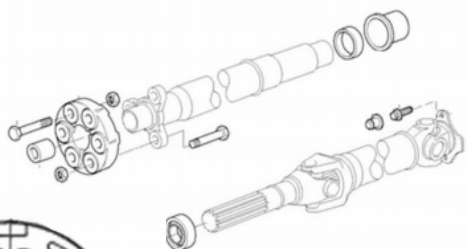
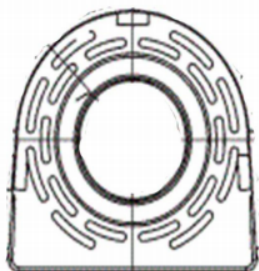

ESPECIFICACIONES

S/BAL/PARA SOPORTE  
(1006,1005) BAL 88509

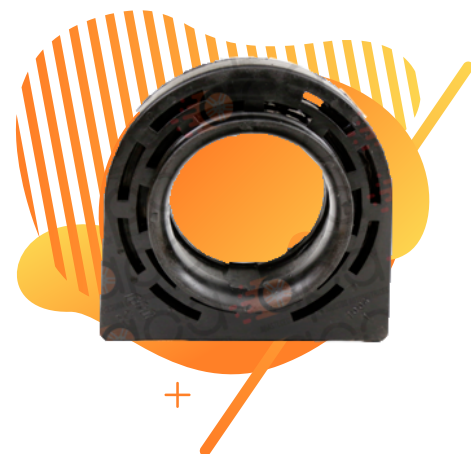

GOMA SOPORTE  
FLECHA CARDAN/  
SOPORTE FLECHA  
CARDAN





EQUIPO  
PESADO

1005

DODGE // **DINA**



CHEVROLET  
DODGE DINA  
INTERNATIONAL

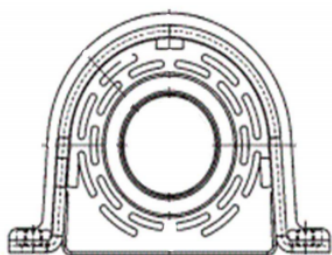
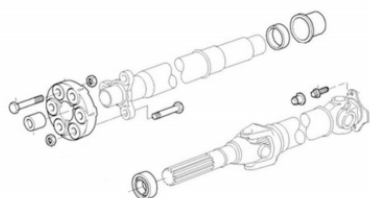

ESPECIFICACIONES

HERRAJE, GOMA PARA  
BAL 88509

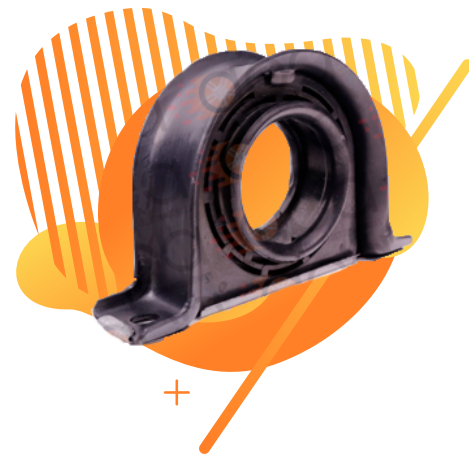

1006

DODGE // **DINA**



CHEVROLET  
DODGE DINA  
INTERNATIONAL

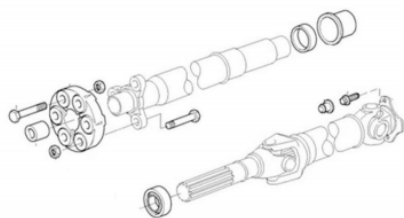

45 MM

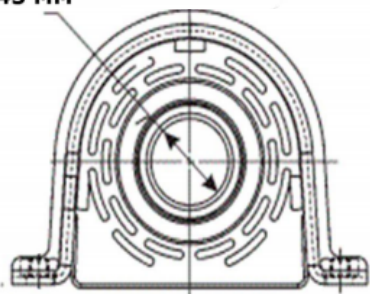

ESPECIFICACIONES

Ø INT. 45MM BAL 88509



GOMA SOPORTE  
FLECHA CARDAN/  
SOPORTE FLECHA  
CARDAN





EQUIPO  
PESADO

1007

DODGE // **DINA**



CHEVROLET  
DODGE DINA  
INTERNATIONAL  
FORD

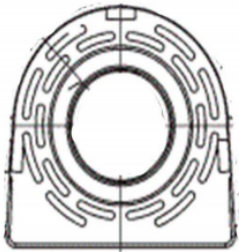
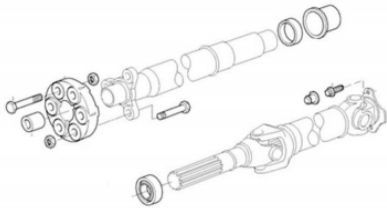

ESPECIFICACIONES

S/BAL/ PARA SOPORTES  
(1008,1009)

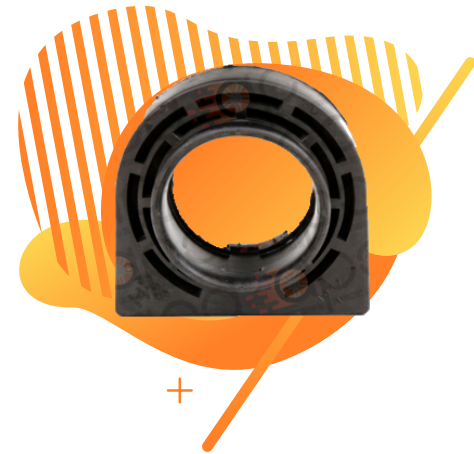

1008

DODGE // **DINA**



CHEVROLET  
DODGE DINA  
INTERNATIONAL  
FORD

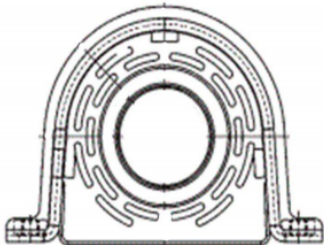
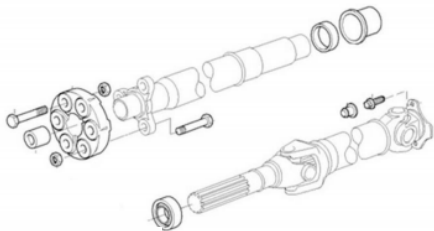

ESPECIFICACIONES

HERRAJE, GOMA PARA  
BAL 88508



GOMA SOPORTE  
FLECHA CARDAN/  
SOPORTE FLECHA  
CARDAN



EQUIPO PESADO

1009

DODGE // **DINA**



CHEVROLET  
DODGE DINA  
INTERNATIONAL  
FORD

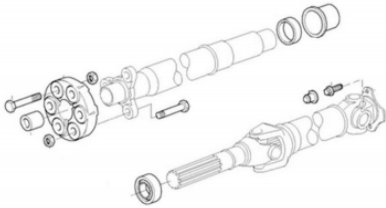

40 MM

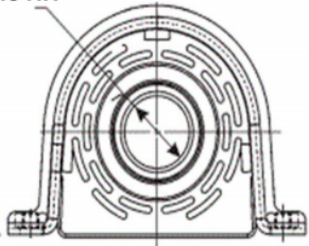

ESPECIFICACIONES

Ø INT. 40MM. BAL 88508



1010

**DINA**

DINA

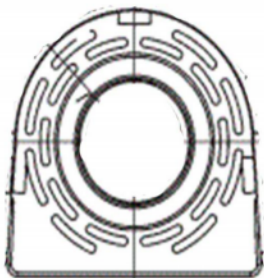
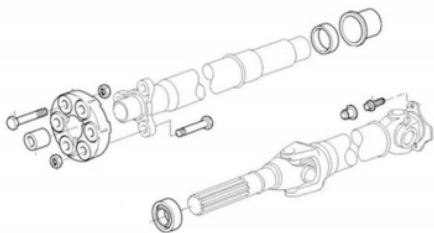

ESPECIFICACIONES

S/ BAL/ PARA SOPORTES  
(1012,1011)



GOMA SOPORTE  
FLECHA CARDAN/  
SOPORTE FLECHA  
CARDAN



1011

**DINA**

DINA

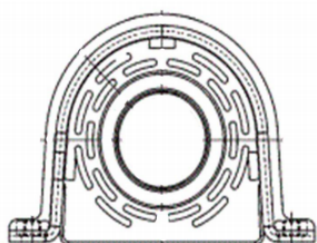
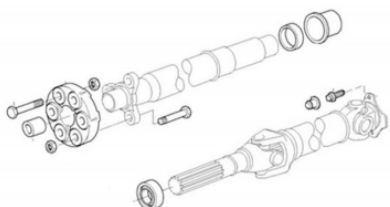

ESPECIFICACIONES

HERRAJE , GOMA PARA  
BAL 88510



1012

**DINA**

DINA

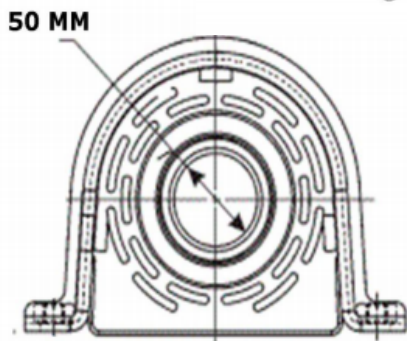
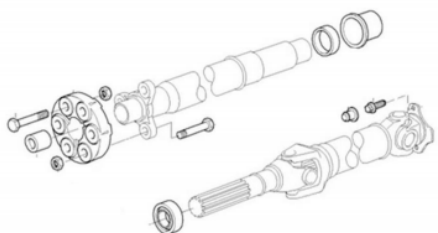

ESPECIFICACIONES

Ø INT. 50MM. BAL 88510

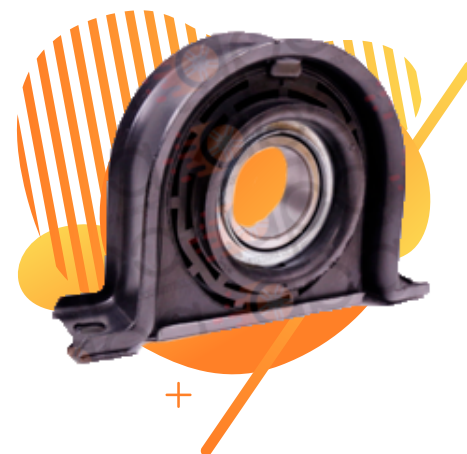

GOMA SOPORTE  
FLECHA CARDAN/  
SOPORTE FLECHA  
CARDAN





EQUIPO  
PESADO

1013



**DINA**

MERCEDES  
BENZ DINA

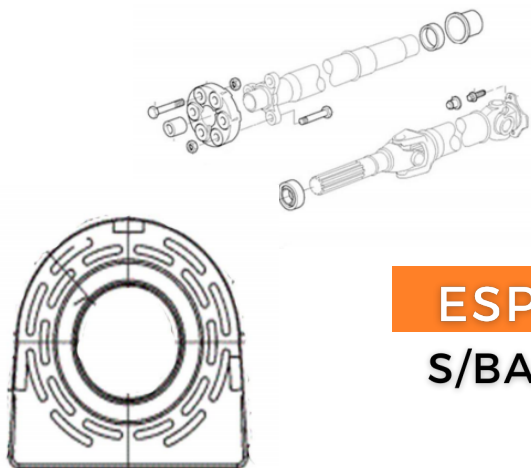

ESPECIFICACIONES  
S/BAL/ PARA SOPORTE  
(1015,1014)

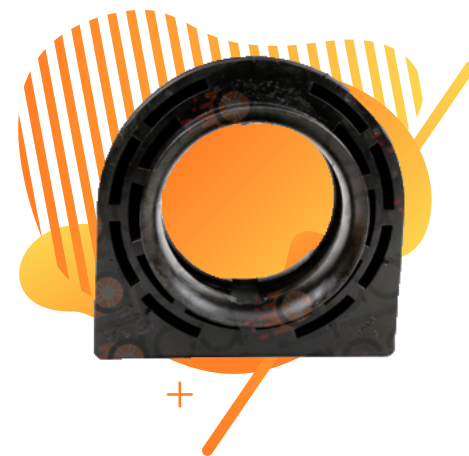

1014



**DINA**

MERCEDES  
BENZ DINA

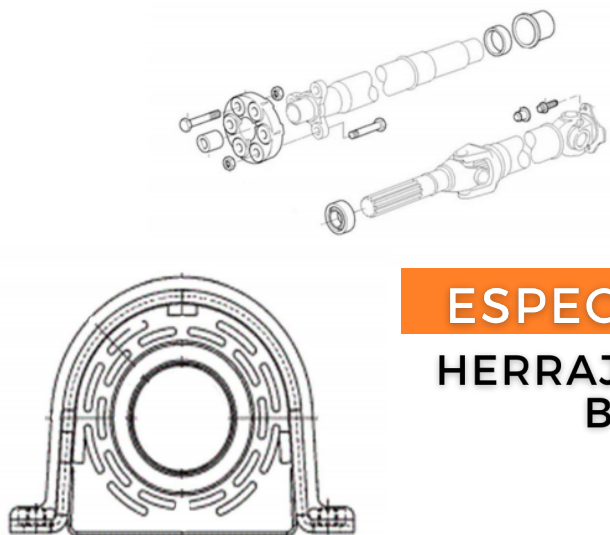

ESPECIFICACIONES  
HERRAJE, GOMA PARA  
BAL 88512

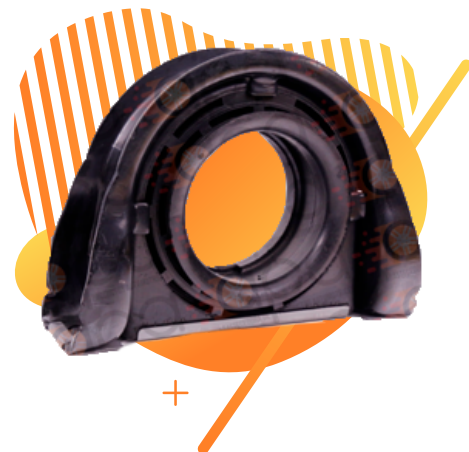

GOMA SOPORTE  
FLECHA CARDAN/  
SOPORTE FLECHA  
CARDAN



EQUIPO  
PESADO

1015



**DINA**

MERCEDES  
BENZ DINA

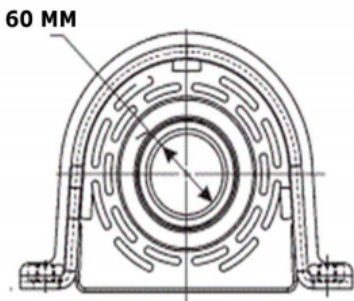
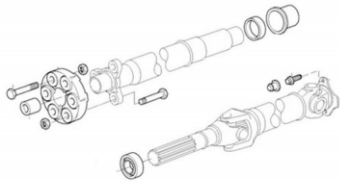

ESPECIFICACIONES

Ø INT. 60MM BAL 88512

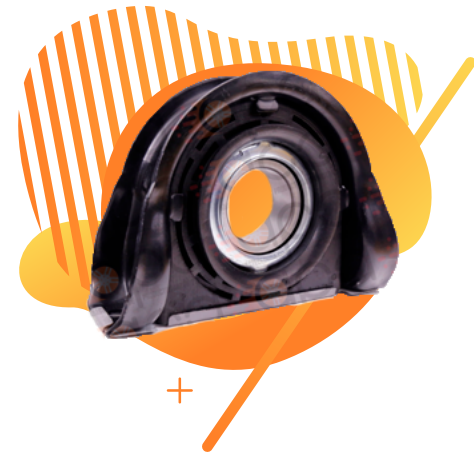

1015 A

**SPICER®**

SPICER

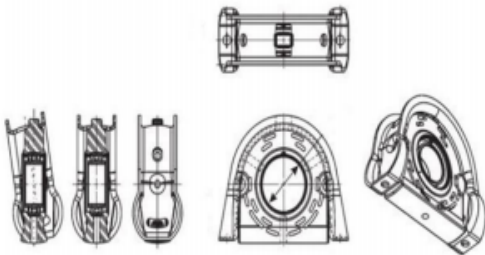
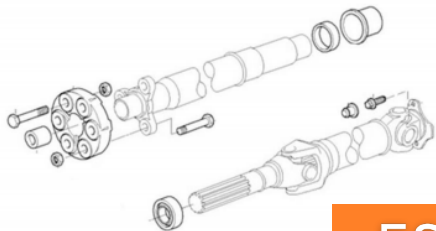

ESPECIFICACIONES

ID 47.32" (107.16MM)  
H 7 13/32" (188.12MM)  
LG 7 5/8" (196.68MM)  
TK 2" (50.80MM)

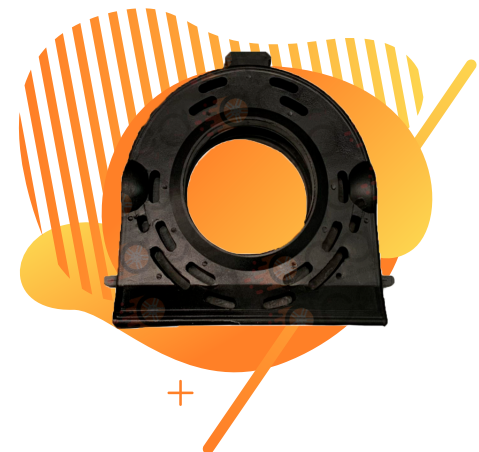

GOMA SOPORTE  
FLECHA CARDAN/  
SOPORTE FLECHA  
CARDAN



**EQUIPO  
PESADO**

**T88107**



**ESPECIFICACIONES**

**TAPA DE BALERO PARA  
SOPORTE FLECHA  
CARDAN 1003  
BALERO (B88107)**

**TAPAS DE  
BALERO**

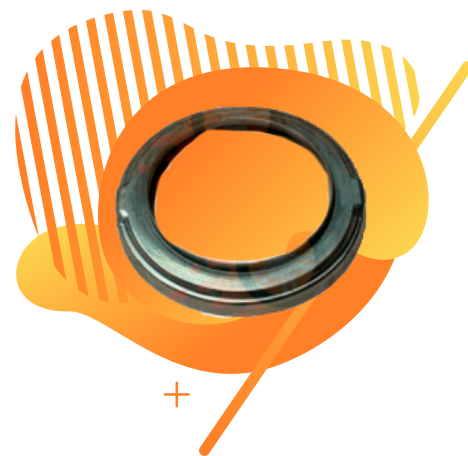

**T88508**



**ESPECIFICACIONES**

**TAPA DE BALERO PARA  
SOPORTE FLECHA  
CARDAN 1009  
BALERO (B88508)**

**TAPAS DE  
BALERO**

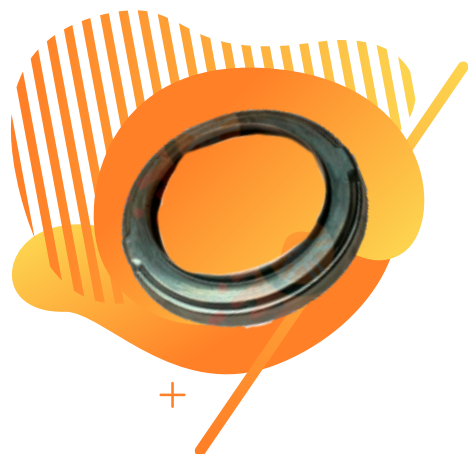

**TAPAS DE  
BALERO**





**EQUIPO  
PESADO**

**T88509**



**ESPECIFICACIONES**

**TAPA DE BALERO PARA  
SOPORTE FLECHA  
CARDAN 1006  
BALERO (B88509)**

**TAPAS DE  
BALERO**

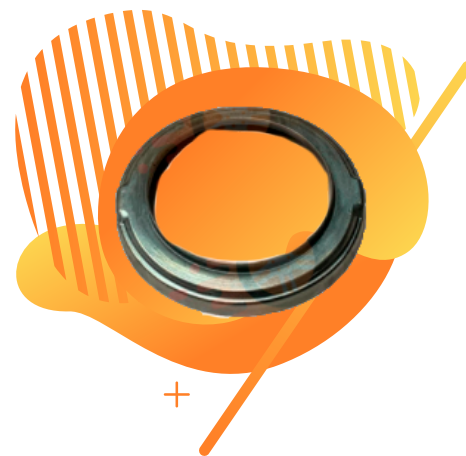

**T88510**



**ESPECIFICACIONES**

**TAPA DE BALERO PARA  
SOPORTE FLECHA  
CARDAN 1012  
BALERO (B88510)**

**TAPAS DE  
BALERO**

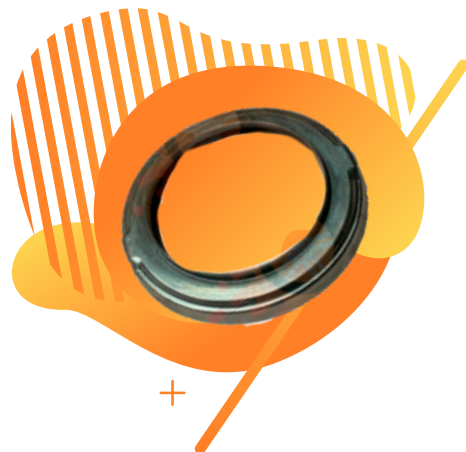

**TAPAS DE  
BALERO**



**EQUIPO  
PESADO**

**T88512**



**ESPECIFICACIONES**

**TAPA DE BALERO PARA  
SOPORTE FLECHA  
CARDAN 1015  
BALERO (B88512)**

**TAPAS DE  
BALERO**



**TAPAS DE  
BALERO**

